

# Gimblet Rock Holiday Park, Pwllheli

## Leisure Complex

Plus Design and Build's ability to produce outstanding designs and manage commercial projects to a highly successful conclusion is demonstrated again at Gimblet Rock.

### The Client

Gimblet Rock Holiday Park, which sits in a stunning coastal location near Pwllheli on the Llyn peninsular, is owned and managed by residential and holiday home specialist, the Haulfryn Group.

### The Brief

When the Haulfryn Group decided to invest in new leisure facilities at Gimblet Rock, management had no hesitation in turning to Plus Design and Build (PDB). "We have always been extremely pleased with similar design and build projects that PDB have completed for us at other locations in North Wales so we knew that this leisure complex would be just as imaginative, functional and successful," said CEO Rod Tucker.

### The Specification

Designed by PDB's architects to both blend into the wonderful North Wales landscape and provide a functional and attractive leisure environment, the new complex offers a range of facilities. These include an indoor swimming pool with integral

children's splash pool and viewing area; a fitness suite; changing rooms and a reception area complete with its own kitchen, office and store room. There is also a welcoming bar and refreshment area with fully glazed walls to take advantage of the stunning views over Cardigan Bay.

The low level, square building is of timber framed construction, finished externally with block and render. It has an offset pyramid-shaped concrete tiled roof with feature roof light. Full height windows which frame the landscape and a stunning front elevation, with floor-to-eaves glass entrance, all combine to give the building immediate impact as visitors approach.





Internally, the high vaulted ceiling constructed from glulam laminated timber gives a light, airy feel to the communal areas, maximising natural light and ventilation.

Without doubt the main attraction is the 12m x 6m swimming pool with integral children's pool. Daylight floods into the pool area via the glazed pyramid roof light.

Significant time and cost savings were made possible thanks to the offsite production of the timber framed structure, which was designed and manufactured in PDB's specially equipped factory. Other benefits of this method of construction include reduced labour costs, less waste and disruption on site and a reduction in safety risks.





#### Client Benefits

Commenting on the new facility, Gimblet Rock's Park Manager Kevin Roberts says: "Our residents are very impressed with the new building and the facilities it provides. It is used regularly by them and they know they can now visit their holiday home, confident in the knowledge that they will have an excellent time, regardless of the weather. Without doubt this facility has been a major factor in attracting new holiday home owners to our park."

Client: The Haulfryn Group  
Location: Gimblet Rock Holiday Park, Pwllheli

# FLOORPLAN

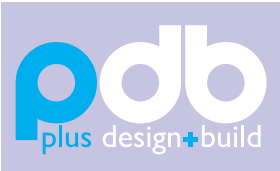
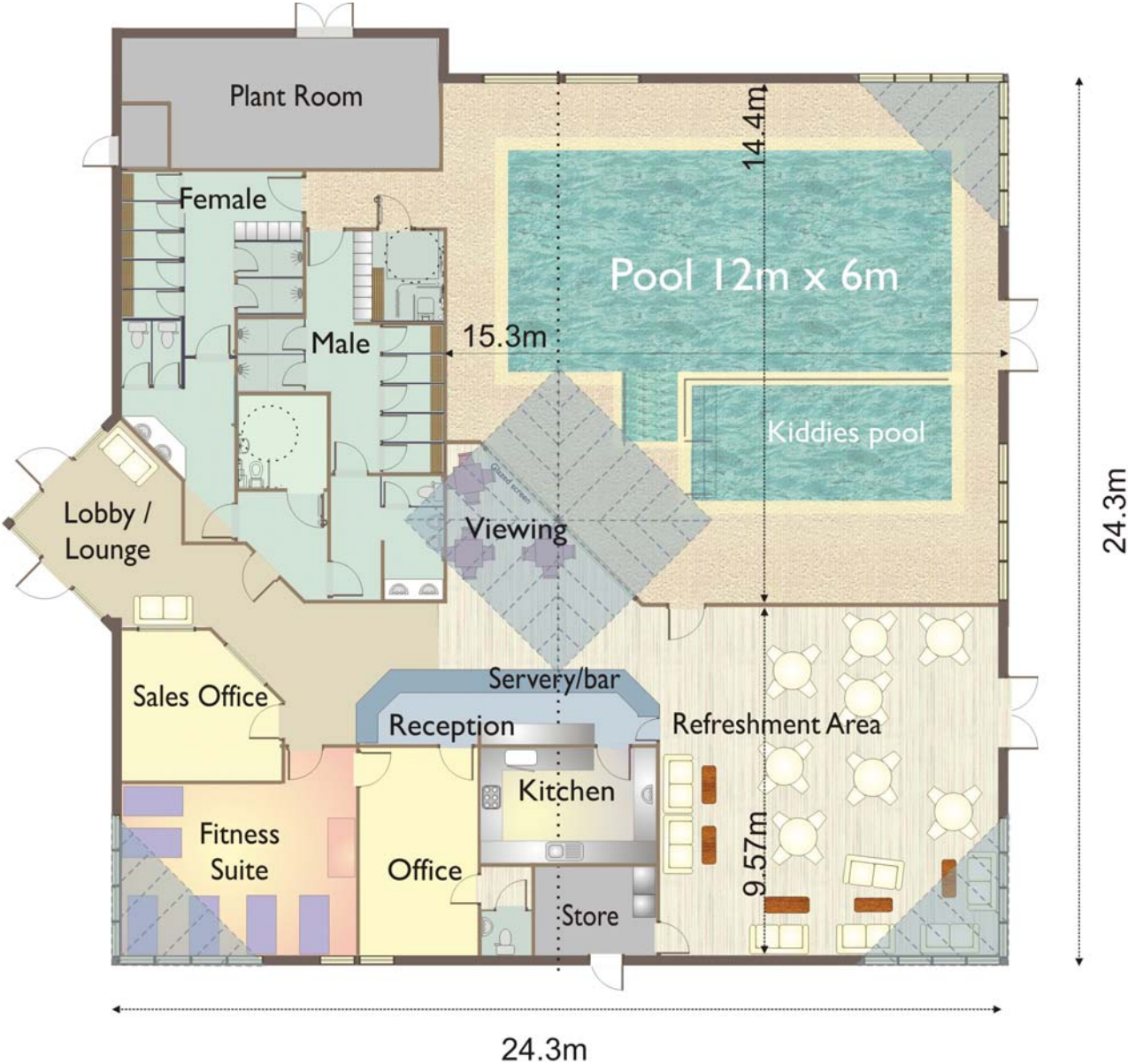

Plus Design and Build Limited  
Riverside Business Park Bakewell Derbyshire DE45 1GS  
01629 816770 admin@plusdesignbuild.co.uk  
[www.plusdesignbuild.co.uk](http://www.plusdesignbuild.co.uk)